

Drawn By: CK
 Designer: CEC
 Manager: DSS
 9/14/2004 ISSUED FOR PROPOSAL REQUEST NO. 1
 9/9/2004 ISSUED FOR HEALTH DEPARTMENT SUBMITTAL
 4/16/2004 ISSUED FOR PERMITS
 3/25/2004 ISSUED FOR OWNER REVIEW & PRICING
 Grand Rapids, Michigan (616) 575-3824
 Copyright 2005 All Rights Reserved

FTGH
 Fishbeck, Thompson, Carr & Huber
 Engineers & Scientists & Architects

LYNWOOD
 ALDERWOOD MALL
 LOEWS THEATRES
 WASHINGTON

PROJECT NO. **G02281EC**
 SHEET NO. **A102**

NOTE: SHADDED AREAS NOT INCLUDED IN FLOOR AREA CALCULATIONS

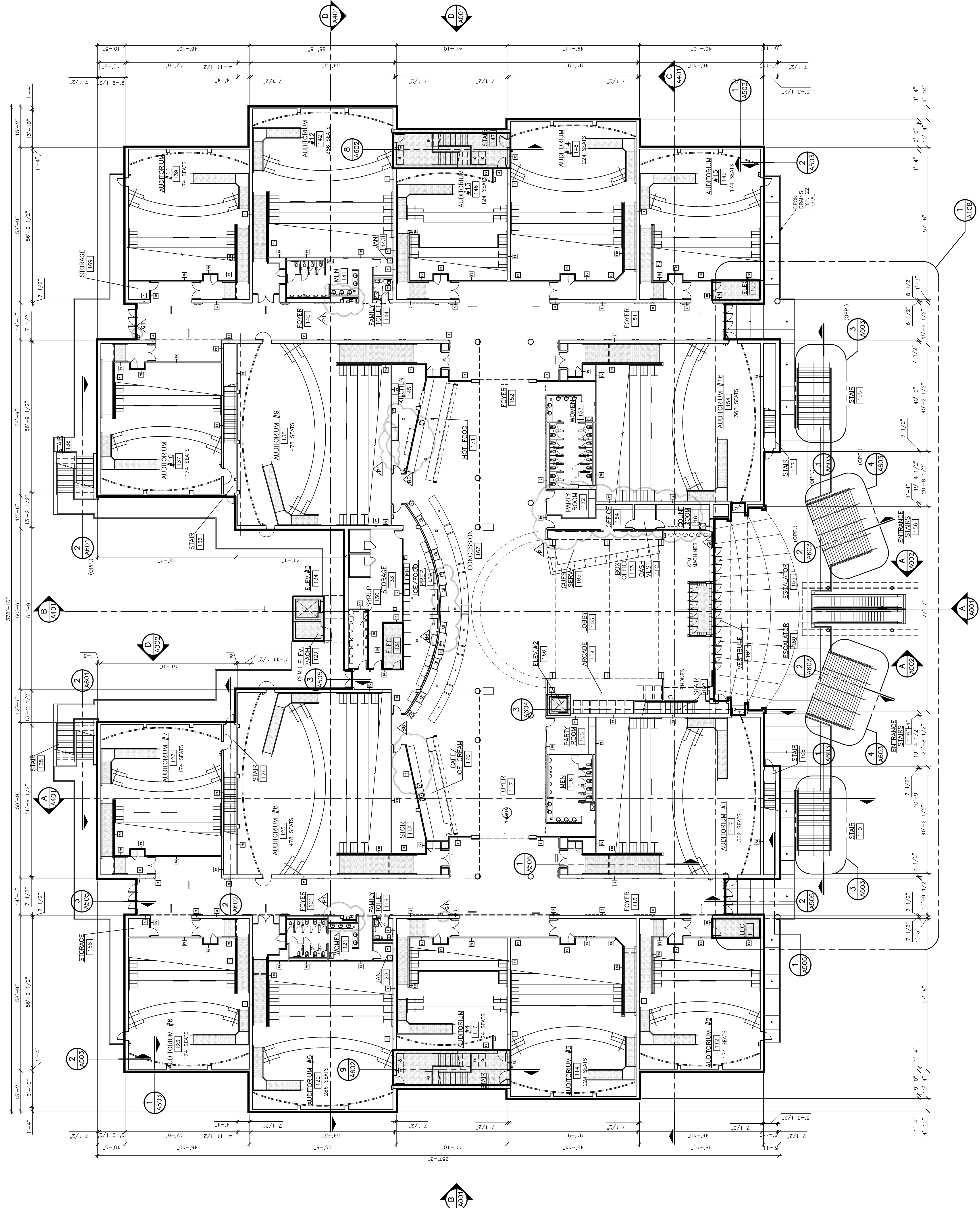

LEGEND
 2 HOUR FIRE RATED WALL
 1 HOUR FIRE RATED WALL

OVERALL MAIN LEVEL FLOOR PLAN
 SCALE: 1/16" = 1'-0"
 0 5 10 15 20 25 30 35



AUDITORIUM SUMMARY

AUDITORIUM SIZE	QUANTITY	TOTAL SEATS	PLATFORM WIDTH	RISE/HEIGHT
124	2	248	3'-8"	12" & 18"
174	6	1044	3'-8"	12" & 18"
224	2	448	4'-0"	12" & 18"
286	2	572	4'-0"	12" & 18"
362	2	724	4'-0"	14" & 18"
478	2	956	4'-0"	14" & 18"
TOTAL	16	3992		