

# Loews Theater Alderwood

Lynnwood Washington

16 screens, elevated theater with parking below.

My role in this project included:

- Being part of the production team.
- Detailing and layout refining.
- Checking shop drawings.
- Coordinate construction documents with electrical, mechanical, and structural engineers.



Concession stand and waiting area



Escalator canopy

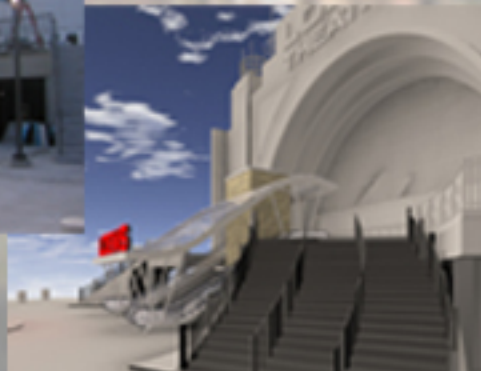

After the first construction cost estimate, Loews Theaters decided to trim the budget. My role in this effort was to redesign the enclosure for the exterior escalators and elevator. Prior to redesign the enclosure was a large square box with glass on the side and open at the front and back.

I contacted the escalator / elevator manufacturer and determined the minimum structure need to protect the escalators and elevator. After evaluating several options and discussing them with team members, we agreed upon a gracefully double curve that complements the theater entry.

I was responsible of coordinating and documenting all the changes, including contacting vendors and refining the design with the structural engineers.